

Cyclone
Dust Collection
Unit

Collinson 

USER
MANUAL

CE

Contents

1	Disclaimer	2
2	General Information	3
2.1	Intended Use.....	3
2.2	Delivery and Installation	3
2.3	Maintenance.....	3
2.4	Cleaning.....	3
2.5	Health & Safety	3
2.6	Liability and Warranty.....	4
2.7	Customer Service.....	4
2.8	Precautions and Recommendations	4
2.9	Signage	5
2.10	End of Life	6
2.11	EC Declaration of Conformity	6
3	Technical Information	7
4	User and Assembly Guide	8
4.1	General Specification	8
4.2	Manual Handling of the Cyclone Dust Collector.....	10
4.3	Assembly Instructions	11
5	Operation Instructions – How to empty the cyclone dust collector	13
6	Cleaning Instructions	14
7	Appendix 1 - Product Information Drawings	15
7.1	BCP-3UNIT – Cyclone dust collector – no bracket	15
7.2	BCP-3UNIT-03 – Cyclone dust collector with bracket for three legged silo	16
7.3	BCP-3UNIT-04 - Cyclone dust collector with bracket for four legged silo.....	17
7.4	BBB-QSL05 - Cyclone dust collector with bracket for drive under silo	18
7.5	BCP-3UNIT-06	19
7.6	BCP-3UNIT-07	20
7.7	BCP-3UNIT-08	21
7.8	BCP-3UNIT-09	22
8	General Terms and Conditions.....	23

1 Disclaimer

The original, authoritative version of this manual is the English version produced by E Collinson & Co Ltd. Subsequent changes to any manual made by any third party have not been reviewed nor authenticated by E Collinson & Co Ltd. Such changes may include, but are not limited to, translation into languages other than English, and additions to or deletions from the original content. E Collinson & Co Ltd disclaims responsibility for any and all damages, injuries; warranty claims and/or any other claims associated with such changes, as such changes made result in content that is different from the authoritative version.

Every care has been taken to ensure that the contents of this publication are accurate but E Collinson & Co Ltd do not accept responsibility for any errors or information which is found to be misleading, should you observe any questionable content in any manual, please notify E Collinson & Co Ltd immediately.

This user manual is a reference for Cyclone Dust Collection Unit only.



It is the user responsibility to check that this manual refers to the relevant product model.

2 General Information

Thank you for choosing a Collinson Cyclone Dust Collector. To ensure correct installation and get the best results from your Cyclone we recommend you read this user manual.

Products manufactured by E Collinson & Co Ltd are safe and without risk provided they are installed, operated and maintained in good working order in accordance with our instructions and recommendations.

2.1 Intended Use

This product has been designed and manufactured to collect dust generated during the pneumatic filling of your silo in order to keep the silo base and surrounding area clean and dust free.

The Cyclone should not be used for anything other than the intended use only. Any alternative use will be at the responsibility of the operator.

2.2 Delivery and Installation

The Cyclone is designed to be transported with a new silo purchase or via on a carrier for connection to an existing silo onsite.

Please refer to Section 4.3 for full installation instructions.

2.3 Maintenance

The Cyclone requires minimal maintenance. We recommended cleaning the Cyclone periodically to prevent any build up of feed dust.

It is the responsibility of the owner to assess the process and ensure that all operators are trained in safe working practices.

2.4 Cleaning

The design of the Cyclone facilitates straightforward cleaning using an airline or brush.

Please refer to Section 6 for full cleaning guidelines.

2.5 Health & Safety

It is the responsibility of the person in charge of the Cyclone to provide a suitable risk assessment, method statement and full training to all employees.

Suitable Personal Protective Equipment (PPE) should be worn during installation, maintenance and cleaning.

All Cyclones carry personnel hazard notices relating to safe operation procedures. See signage in Section 2.9.

Manual handling of the Cyclone should be assessed prior to moving. See Section 4.2.

It is recommended that any power tools used are battery powered and are in correct working order before commencing any work.

The Cyclone should be operated utilising the handle. Hands and fingers should remain clear from the chute body and door. For operating guidance see Section 5.

2.6 Liability and Warranty

When operated in line with our recommendations and no modifications take place, the Cyclone is guaranteed against material and manufacturing defects for twelve months from the date of purchase invoice.

E Collinson & Co Ltd will not be responsible for any consequential loss due to negligence caused by failure to adhere to the guidelines laid out in the user manual.

This Cyclone has been designed for use with E Collinson & Co Ltd silos manufactured since 2010 and fitting instructions are included in this manual.

The Cyclone is suitable for dust collection on other makes and models of silo however E Collinson & Co Ltd are unable to advise any best fitting solutions for other silos from other suppliers. Any alterations or modifications are at the complete discretion of the silo operator.

2.7 Customer Service

Our dedicated Customer Service Team can offer help, support, send out spare parts or arrange service visits. You can contact the team on +44 (0) 1995 606 451.

Office Hours are Monday – Thursday (GMT) 08:30am – 5pm
Friday 08:30am – 4pm

2.8 Precautions and Recommendations

Do's

- Enjoy a dust free silo base with your new Cyclone.
- Enjoy improved onsite biosecurity.
- Empty the Cyclone after every fill.
- Ensure the Cyclone is empty before cleaning out.
- Undertake regular cleaning see (Section 6).
- Wear suitable PPE when handling the Cyclone.

Do Not

- Allow the dust collection level to exceed the max line.
- Attempt to carry out any maintenance or cleaning on the Cyclone whilst the silo is being pneumatically filled.
- Move the Cyclone without assessing manual handling first.

2.9 Signage

Visual signage is displayed on the Cyclone to identify risks. All employees operating the Cyclone should be familiar with the signage as listed below.

It is Important that these instructions must be read and understood by the user



Dust should be emptied from the cyclone before it reaches the max fill line.

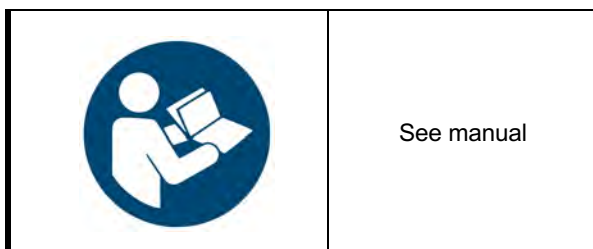

2.10 End of Life

At the end of a very long working life, if required, your Cyclone can be recycled. It is the responsibility of the owner to dispose of the Cyclone in accordance with current environmental regulations.

2.11 EC Declaration of Conformity

The E Collinson & Co Ltd Cyclone is CE marked, designed and manufactured to comply with European standards. CE marking is the manufacturer's declaration that the product complies with the essential requirements of the relevant European health, safety and environmental protection legislation.

A copy of the certificate of declaration is available on request from E Collinson & Co Ltd.

3 Technical Information

Unit Height	1475mm
Unit Weight	Cyclone unit with chute: 17.3Kg Cyclone unit with chute & Bracket: 18.5Kg
Unit Volume	0.0914m ³

Cyclone Construction

HDPE plastic and galvanised steel have been selected as materials of construction for their extreme resistance to atmospheric corrosion.

4 User and Assembly Guide

The Cyclone is transported to site in one of two ways depending on your requirements:

- The Cyclone unit being delivered with your new silo by an E Collinson & Co Ltd driver and installed.
- The Cyclone system will be sent via a courier and installed by the customer.

Confirm your consignment components prior to assembly.

This guide has been provided to give you step-by-step instructions to assemble, install, operate and clean your new Cyclone.

Initial setup of your Cyclone system consists of three simple steps:

- Assembly and Installation
- Operation
- Cleaning

4.1 General Specification

The following component list is relevant to all models of E Collinson & Co Ltd silos.

Note: Different brackets are required for three legged and four legged silos.

Please ensure you have the correct bracket for your silo before commencing the installation. Please refer to Section 7 for all product information drawings.

Component check list:

Description	Illustration	Quantity
Cyclone-Universal-Mounting Assembly		X 1
Cyclone-Universal-Chute & Seal Assembly		X 1

<p>Bracket Kit Silo Leg (Brackets vary for three or four leg models)</p>		<p>X 1</p>
<p>Setscrew-Hex Head-M8 x 20-8.8-ZP</p>		<p>X 4</p>
<p>Washer-T8 Pattern-M8-8.8-ZP</p>		<p>X 8</p>
<p>Nut-Locking-Nylon Type-M8-8.8-ZP</p>		<p>X 4</p>
<p>Q12-FXXXE – Cap – M8 – PVC – White: 2</p>		<p>X 4</p>
<p>QWJ-F40HF – Washer – Penney – M8 x 40 x 1.5 – SS-A2 – DIN9021: 2</p>		<p>X 4</p>
<p>YGY-XW462 – Gasket – Washer 40 o-d x 6 i-d – CCN – 3mm:2</p>		<p>X 4</p>
<p>Q1P-F025P – Setscrew – Hex Head – M8 x 25 – 8.8-ZP:2</p>		<p>X 4</p>
<p>Q1C-FXXXP – Nut – Full – M8 – 8.8-ZP:2</p>		<p>X 4</p>
<p>QSD-DX25F – Screw – Self Drilling – TEK Screw&Washer – 5.5 x 25mm A2/SS 7504K <i>The Bolt Driver for this fixing is not supplied.</i></p>		<p>X 2</p>

4.2 Manual Handling of the Cyclone Dust Collector

Prior to handling the Cyclone Dust Collector it is important to observe the following:

- Consideration must be made to manual handling and any of the Cyclone parts as they may become awkward to position in place especially when being raised from ground level.
- Ensure the silo is not being pneumatically filled before carrying out any maintenance or cleaning on the Cyclone.
- Ensure all correct PPE is worn which includes cut resistant gloves, eye protection, ear protection and adequate footwear.
- Ensure that all parts being moved have been planned in advance to avoid any injuries.
- Ensure that there are no obstructions that may block access to the required silo.
- Seek assistance if required.
- If using steps or a ladder then all personnel must be aware of the working at height regulations.

4.3 Assembly Instructions

Important – If you are retrofitting the Cyclone to your existing silo it is essential that the exhaust pipe is cut to a height of 2200mm from ground level. Ensure any metal work that has been cut has all edges deburred and rounded afterwards.

These instructions refer to all silo models. For product information drawings see Appendix: 7.2 – Three legged silos, 7.3 – Four legged silos, 7.4 – Drive under silos.



1. Decide which side of the silo leg the cyclone will be positioned and fasten the leg brackets as shown in fig 1 using 2 x M8 x 20 Bolts, 2 x M8 Washers and 2 X M8 Locking nuts and fully tighten. Fit bracket 1150mm from ground level to the underside of the leg bracket.



2. Fit the Cyclone mould assembly and the chute & seal assembly together using 4 x M8 x 25 Bolts, 4 x penny washers and gasket washers on the upper side of the Cyclone, 4 x M8 washers on the underside of the Cyclone and 4 x M8 nuts. These only need to be finger tight at this stage. (2 sets of fixings are already in the chute and seal assembly upon delivery).

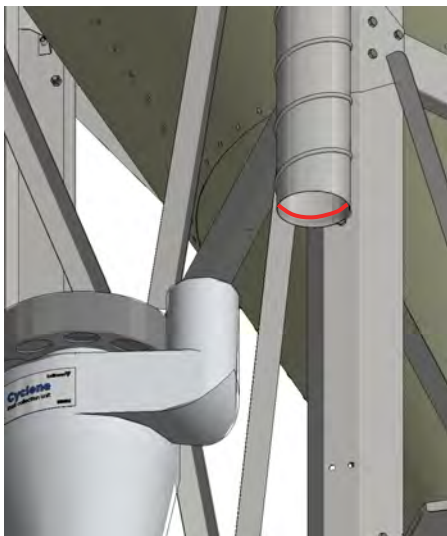

3. Apply sealant around the inside of the exhaust pipe as highlighted in red.

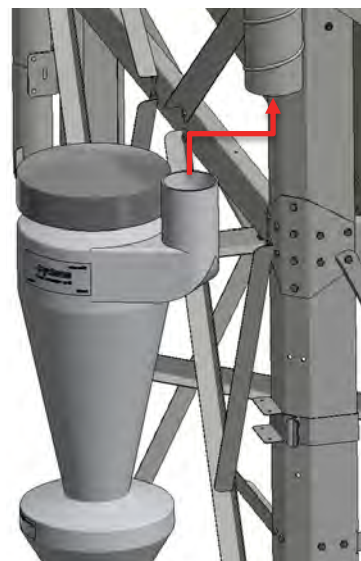

4. Raise Cyclone and insert Cyclone tube into the exhaust pipe of the silo.

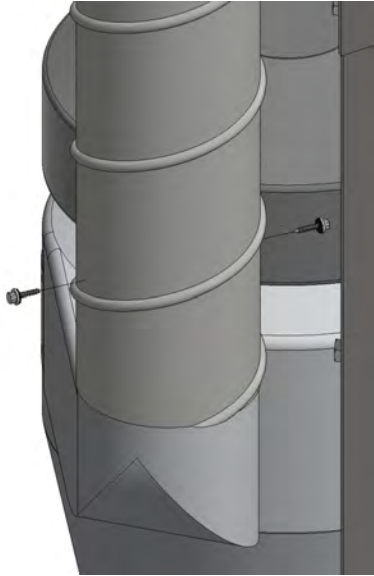

5. Attach 2 x Tek screws to either side of the exhaust pipe securing the Cyclone to the silo.

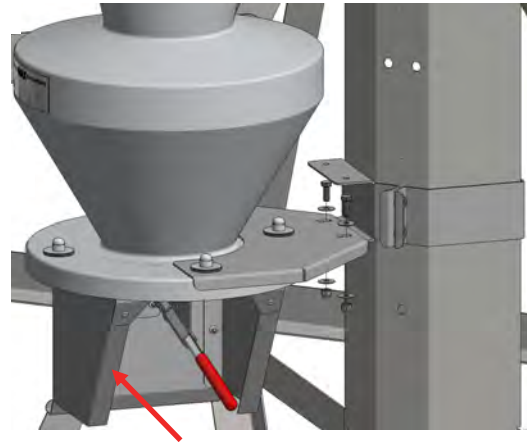

6. Bolt Cyclone onto the leg bracket and bolt with 2 x M8 x 20 Bolts, 4 x M8 Washers and 2 x M8 Locking Nuts and fully tighten.

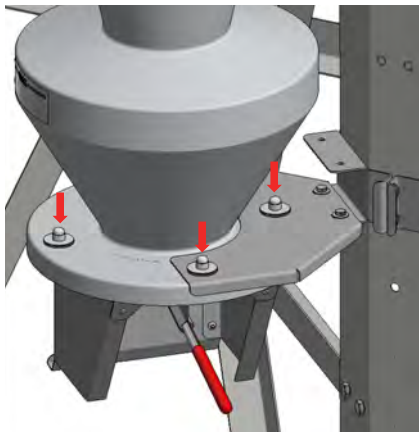

7. Decide the orientation of the chute opening then fully tighten all fixings from step 2.

8. Your Cyclone is now ready to use.

5 Operation Instructions – How to empty the cyclone dust collector

Dust is collected in the chamber at the bottom of the Cyclone, for successful operation this must be emptied before it reaches the max fill line.

Buildup varies dependent upon the material being stored in the silo however it is good practice to discharge the feed following each fill.

To empty the Cyclone simply place a bag, barrow or similar under the chute ready to collect the feed dust before opening the chute.

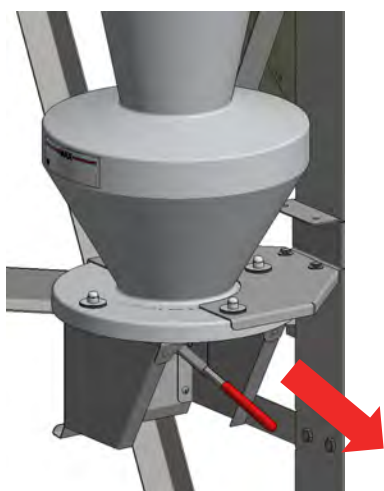

1. With a firm grip on the handle, pull it towards you to open the slide and discharge feed dust into a bag or barrow.

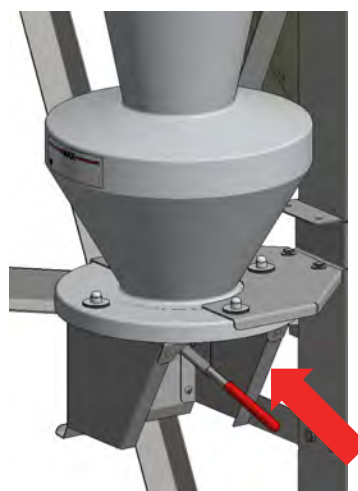

2. Once all dust has been discharged and the Cyclone is empty, push the handle away from you to close the slide.

6 Cleaning Instructions

All cleaning operations should be carefully planned and carried out in a safe manner with an appropriate risk assessment carried out before any work begins. All appropriate PPE must be worn while undertaking cleaning tasks including hand protection, eye protection and a dust mask. If using steps or a ladder then all personnel must be aware of the working at height regulations. Use compressed air or use a suitable brush to perform all cleaning tasks.

- Ensure the silo is not being pneumatically filled before any cleaning or maintenance is carried out on the Cyclone
- The Cyclone must be empty before cleaning.

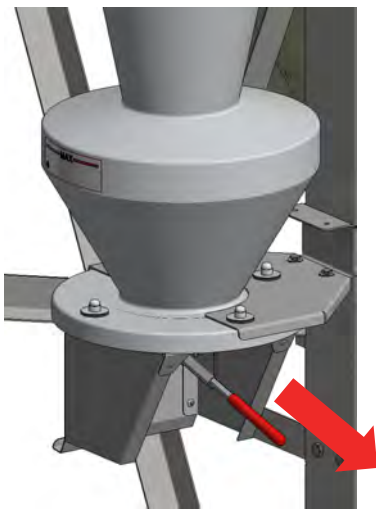

1. With a firm grip on the handle, pull it towards you to open the slide and discharge feed dust into a bag or barrow.

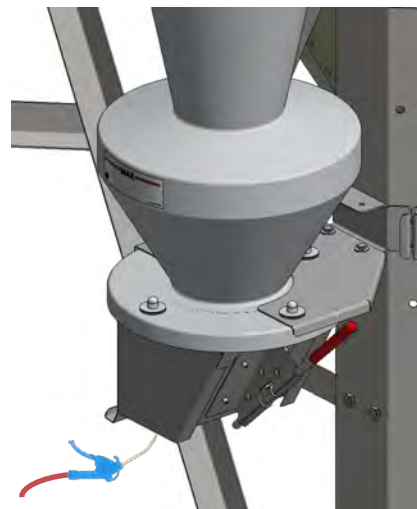

2. Place an airline blower or suitable brush into the opening of the chute Cyclone and begin removing any excess dust which has become stuck.

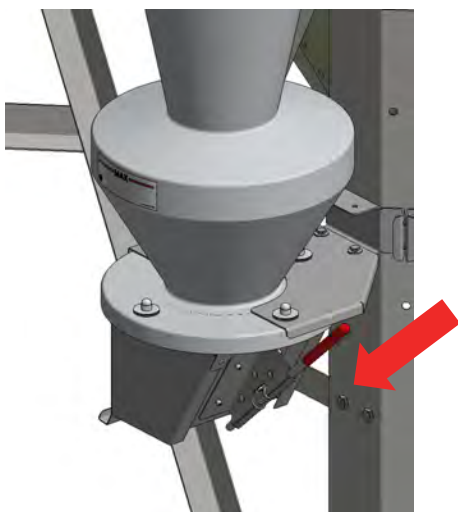

3. Once complete remove all equipment used and firmly push the handle away from you to close the chute.

7 Appendix 1 - Product Information Drawings

7.1 BCP-3UNIT – Cyclone dust collector – no bracket

Cyclone-Uni Dust Collection Unit c/w Integral Chute

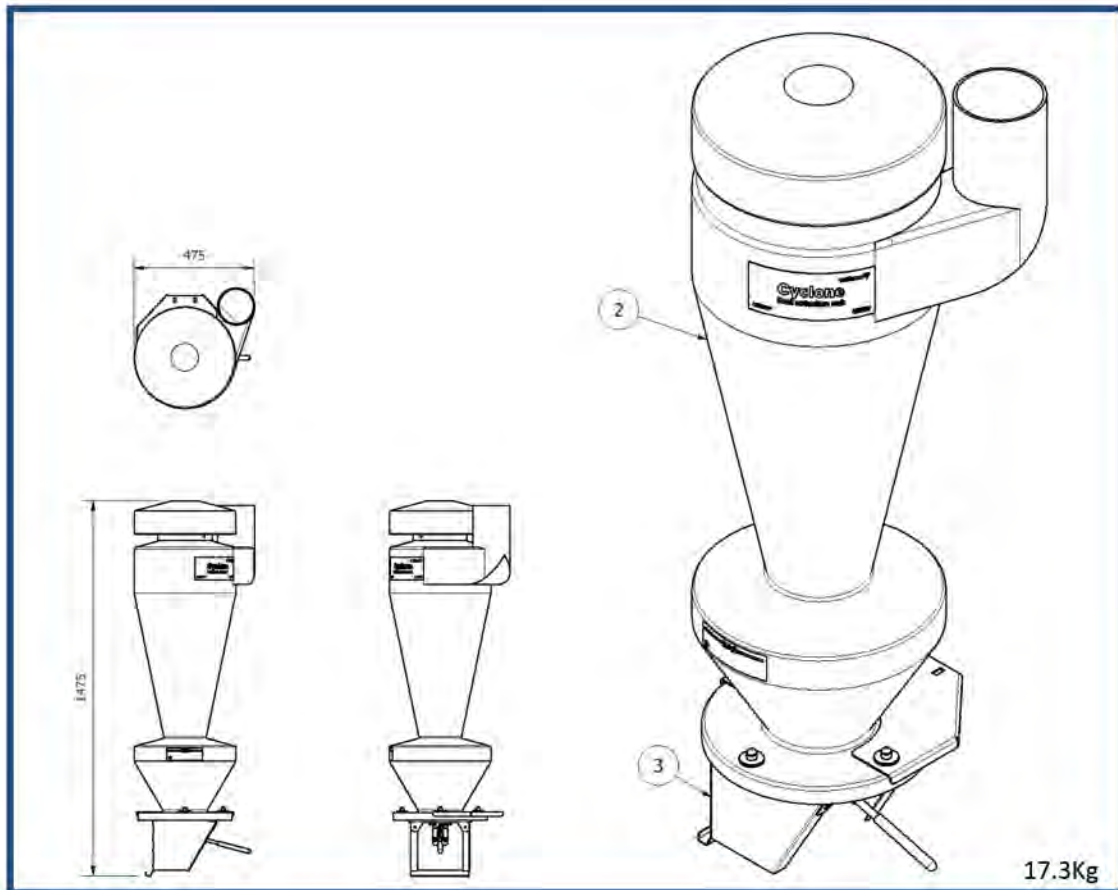

Item	Qty	Part Number	Description
1	1	N/A	Identification label
2	1	126054	Cyclone-Universal-Moulding Assembly
3	1	126127	Cyclone-Universal-Chute & Seal Assembly

7.2 BCP-3UNIT-03 – Cyclone dust collector with bracket for three legged silo

Cyclone-Uni Dust Collection Unit c/w Integral Chute-3leg

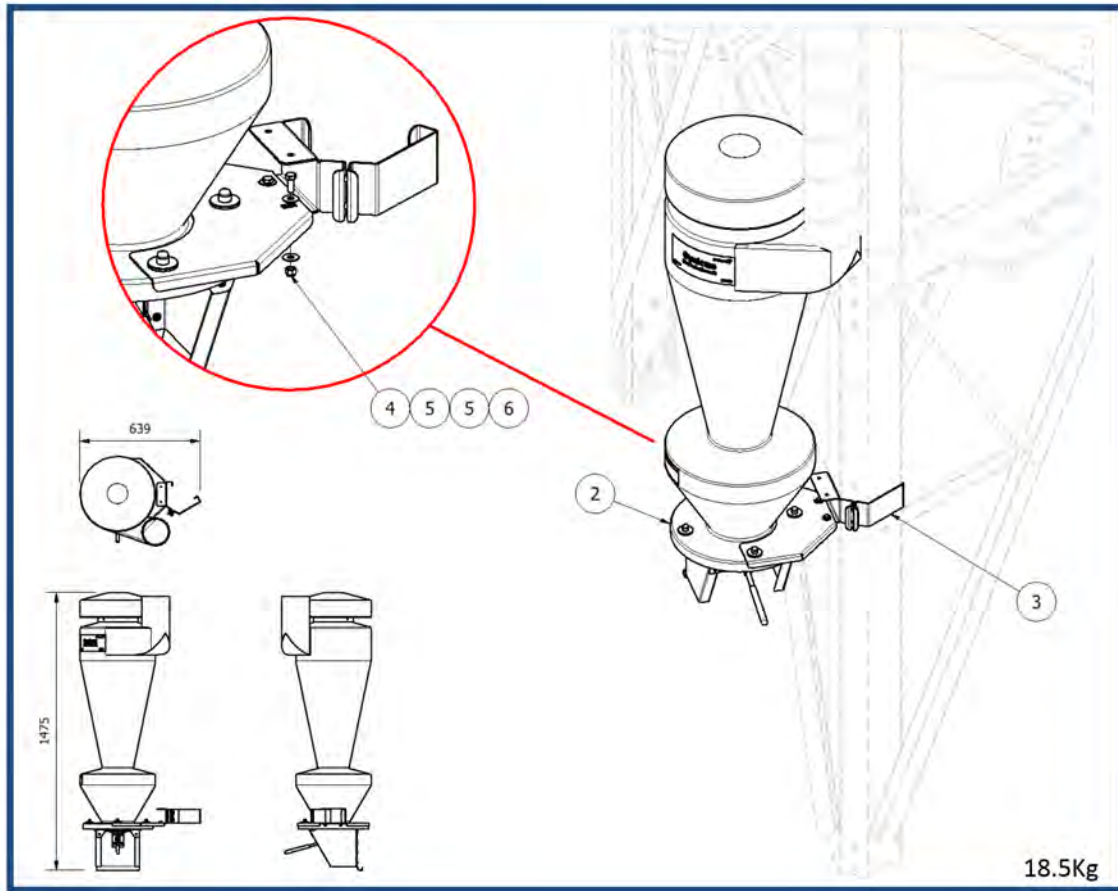

Item	Qty	Part Number	Description
1	1	N/A	Identification label
2	1	BCP-3UNIT	Cyclone-Uni-Dust Collection Unit c/w Integral Chute
3	1	BBB-QSL03	Bracket Kit-Silo Leg-County T Range
BCP-3UNIT-03-FK			
4	2	Q1P-F020P	Setscrew – hex Head – M8 x 20 – 8.8-ZP
5	4	QW8-FXXXP	Washer – T8 Pattern – M8 – 8.8-ZP
6	2	Q1E-FXXXP	Nut – Locking – Nylon Type – M8 – 8.8-ZP

7.3 BCP-3UNIT-04 - Cyclone dust collector with bracket for four legged silo

Cyclone-Uni Dust Collection Unit c/w Integral Chute-4Leg

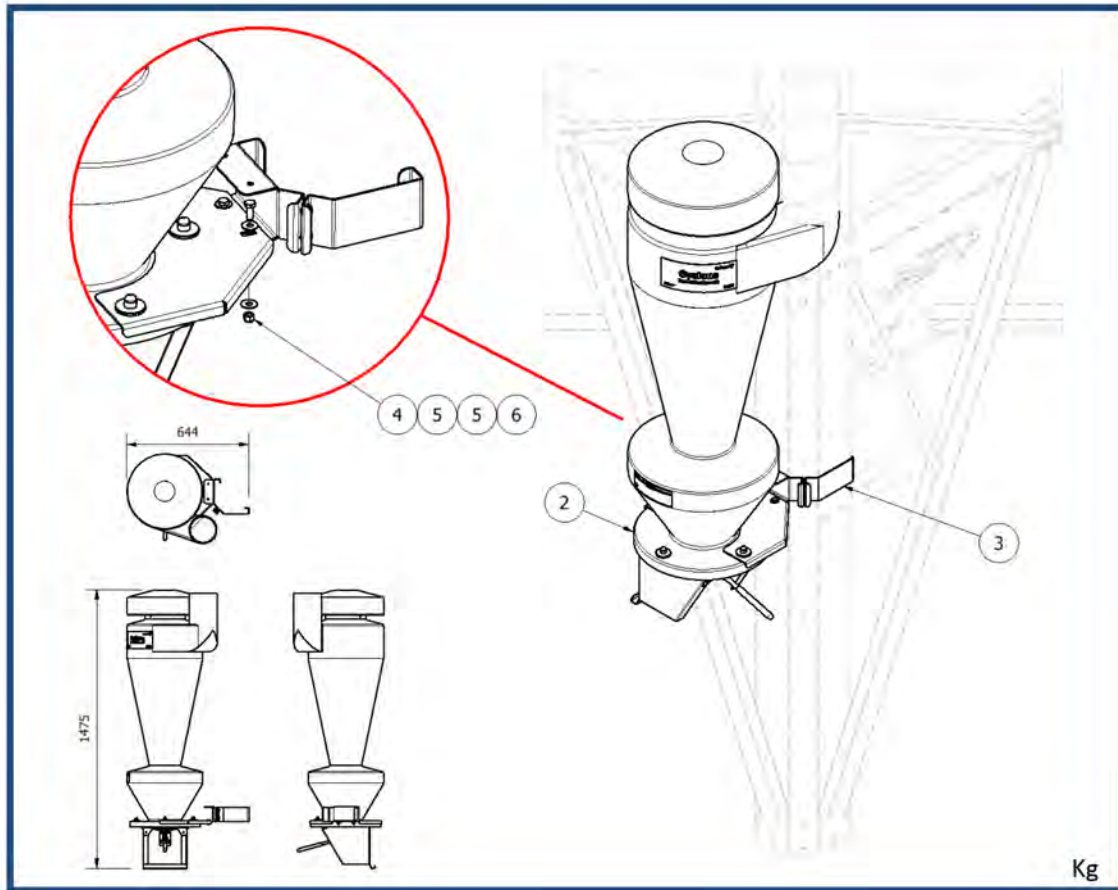

Item	Qty	Part Number	Description
1	1	N/A	Identification label
2	1	BCP-3UNIT	Cyclone-Uni-Dust Collection Unit c/w Integral Chute
3	1	BBB-QSL04	Bracket Kit-Silo Leg-County S Range
BCP-3UNIT-04-FK			
4	2	Q1P-F020P	Setscrew – hex Head – M8 x 20 – 8.8-ZP
5	4	QW8-FXXXP	Washer – T8 Pattern – M8 – 8.8-ZP
6	2	Q1E-FXXXP	Nut – Locking – Nylon Type – M8 – 8.8-ZP

7.4 BBB-QSL05 - Cyclone dust collector with bracket for drive under silo

Bracket Kit-Drive Under

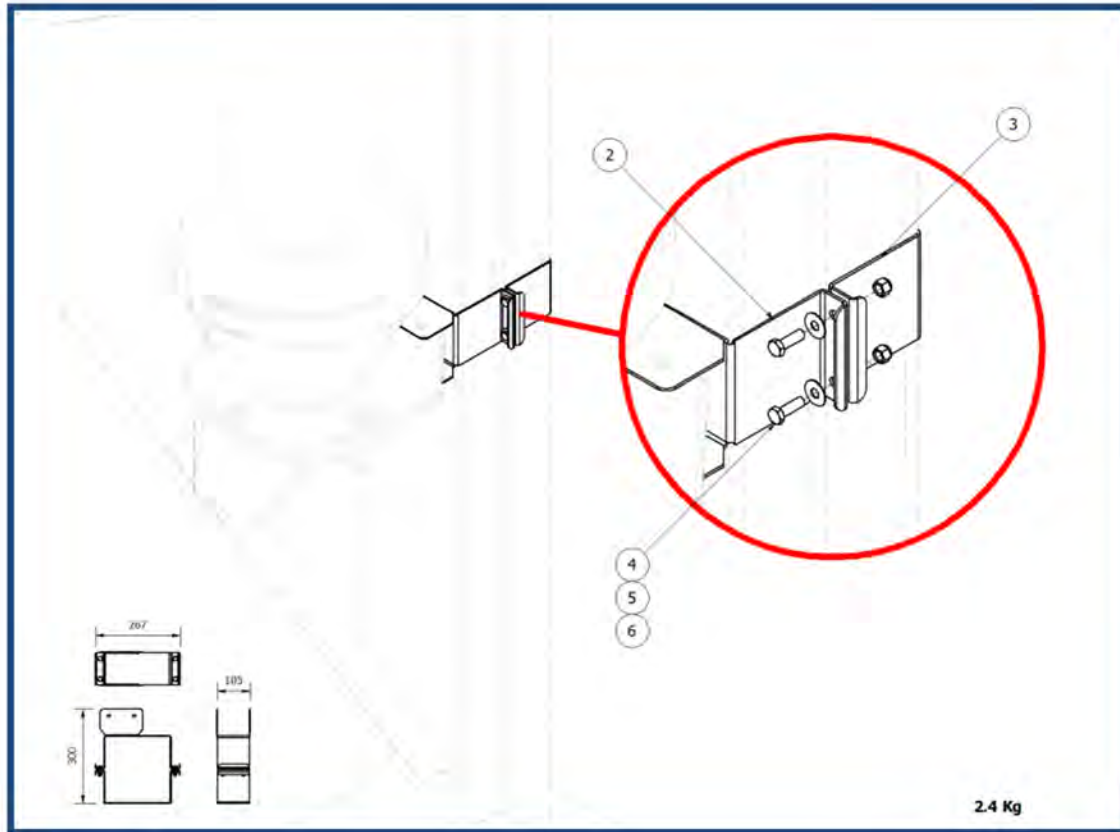

Item	Qty	Part Number	Description
1	1	N/A	Identification Label
2	1	126331	Universal – Leg Bracket – 203x203x60 UC 1
3	1	126332	Universal – Leg Bracket – 203x203x60 UC 2
BBB-QSL05-FK			
4	4	Q1P-F025P	Setscrew - Hex Head - M8 x 25 - 8.8-ZP
5	4	QW8-FXXP	Washer - T8 Pattern - M8 - 8.8-ZP
6	4	Q1E-FXXP	Nut - Locking - Nylon Type - M8 - 8.8-ZP

7.5 BCP-3UNIT-06

Cyclone-Uni Dust Collection Unit integral Chute-Tri Mini LL

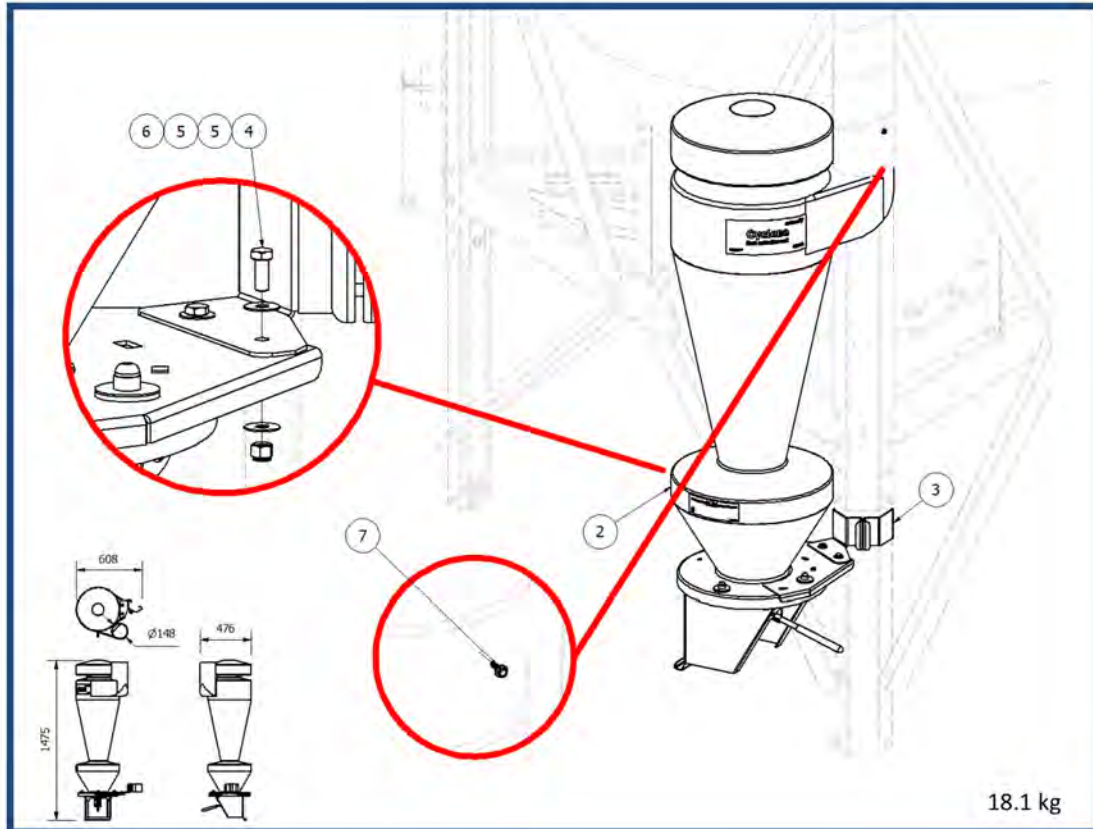

Item	Qty	Part Number	Description
1	1	N/A	Identification Label
2	1	BCP-3UNIT	Cyclone-Uni Dust Collection Unit c/w Integral Chute
3	1	BBB-QSL06	Bracket Kit–Tristor 2.2m-Lower
BCP-3UNIT-06-FK			
4	2	Q1P-F020P	Setscrew – Hex Head - M8 x 20 – 8.8-ZP
5	4	QW8-FXXXP	Washer – T8 Pattern – M8 – 8.8-ZP
6	2	Q1E-FXXXP	Nut – Locking – Nylon Type – M8 – 8.8-ZP
7	2	QSD-DX25F	Screw-Self Drilling - TEK Screw & Washer - 5.5x25mm A2/SS 7504K

7.6 BCP-3UNIT-07

Cyclone-Uni Dust Collection Unit integral Chute-Tri Mini UL

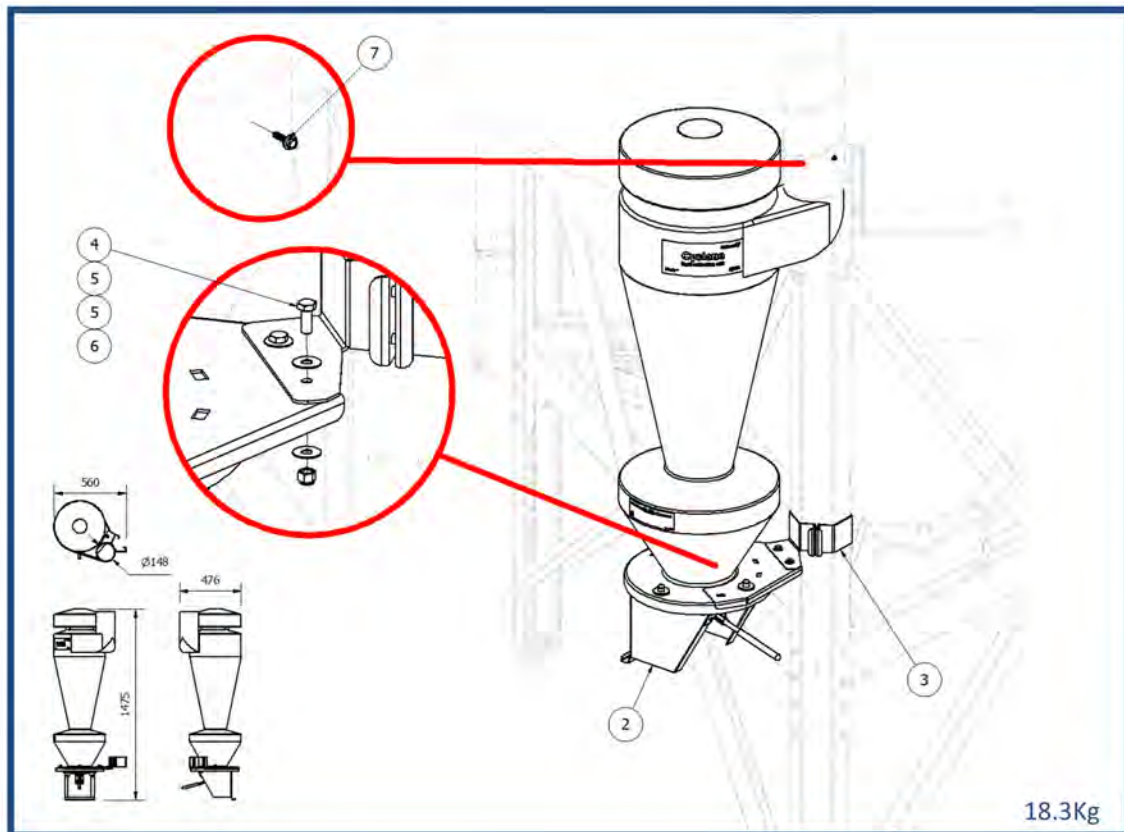

Item	Qty	Part Number	Description
1	1	N/A	Identification Label
2	1	BCP-3UNIT	Cyclone – Unit Dust Collection Unit c/w Integral Chute
3	1	BBB-QSL07	Bracket Kit – Silo Leg – Tristor Mini – Upper
BCP-3UNIT-07-FK			
4	2	Q1P-F020P	Setscrew – hex head – M8 x 20 – 8.8/ZP
5	4	QW8-FXXXX	Washer – T8 Pattern – M8 – 8.8/ZP
6	2	Q1E-FXXXX	Nut – Locking – Nylon Type – M8/ZP
7	2	QSD-DX25F	Screw-Self Drilling - TEK Screw & Washer - 5.5x25mm A2/SS 7504K

7.7 BCP-3UNIT-08

Cyclone-Uni Dust Collection Unit integral Chute-Tri Maxi LL

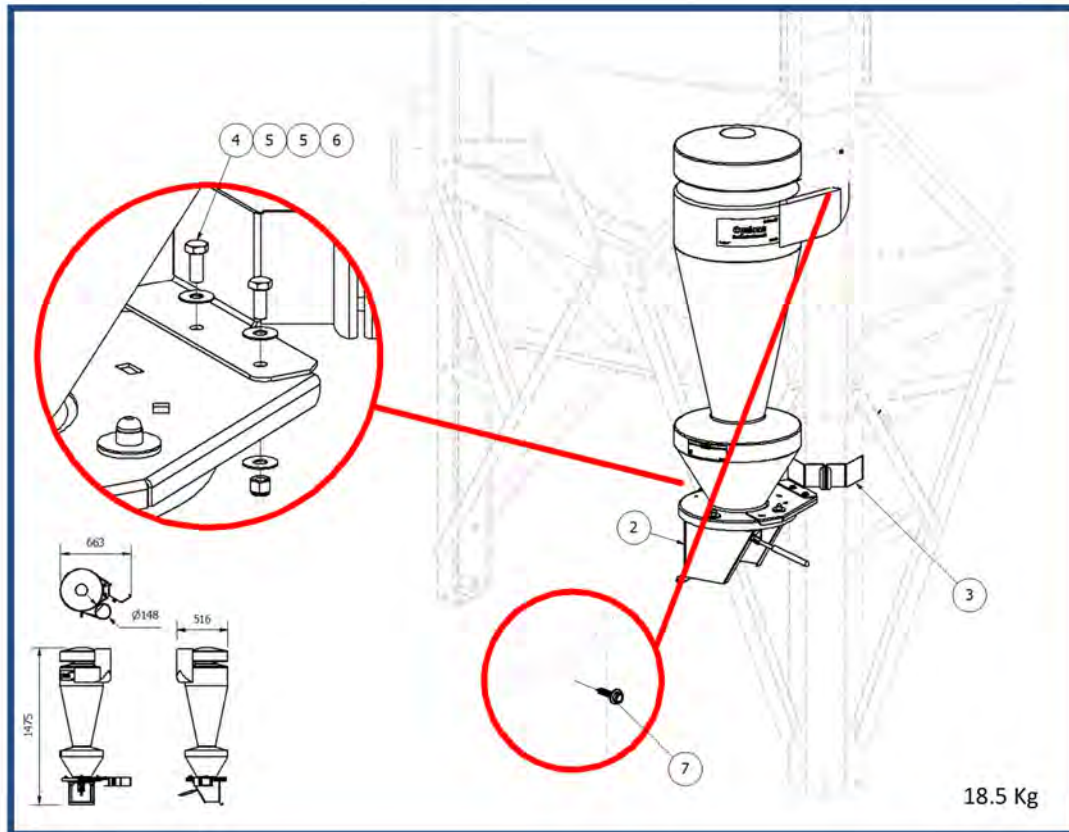

Item	Qty	Part Number	Description
1	1	N/A	Identification Label
2	1	BCP-3UNIT	Cyclone-Uni Dust Collection Unit c/w Integral Chute
3	1	BBB-QSL08	Bracket Kit–Tristor 2.57m-Lower
BCP-3UNIT-08-FK			
4	2	Q1P-F020P	Setscrew – Hex Head - M8 x 20 – 8.8-ZP
5	4	QW8-FXXXP	Washer – T8 Pattern – M8 – 8.8-ZP
6	2	Q1E-FXXXP	Nut – Locking – Nylon Type – M8 – 8.8-ZP
7	2	QSD-DX25F	Screw-Self Drilling - TEK Screw & Washer - 5.5x25mm A2/SS 7504K

7.8 BCP-3UNIT-09

Cyclone-Uni Dust Collection Unit integral Chute-Tri Maxi UL

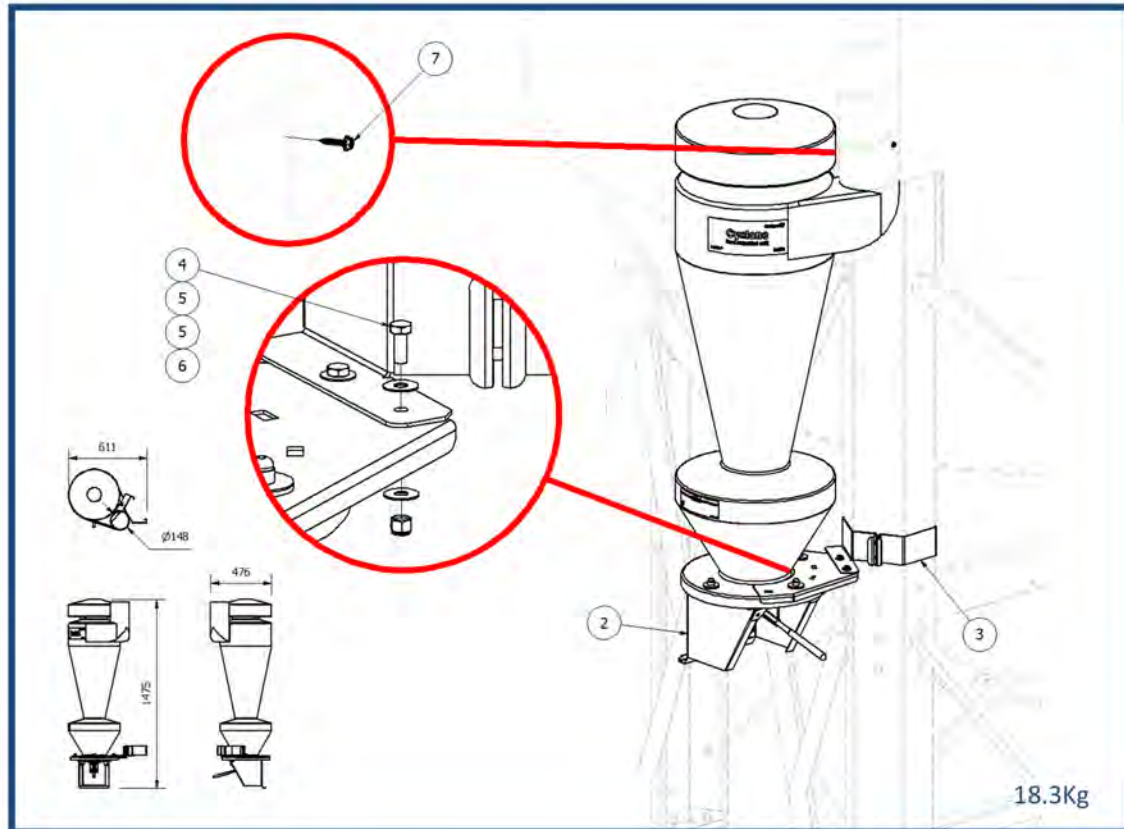

Item	Qty	Part Number	Description
1	1	N/A	Identification Label
2	1	BCP-3UNIT	Cyclone – Uni Dust Collection Unit c/w Integral Chute
3	1	BBB-QSL09	Bracket Kit – Tristor 2.57m – Upper
BCP-3UNIT-09-FK			
4	2	Q1P-F020P	Setscrew – Hex Head – M8 x 20 – 8.8/ZP
5	4	QW8-FXXXP	Washer – T8 Pattern – M8 – 8.8/ZP
6	2	Q1E-FXXXP	Nut – locking – Nylon Type – M8 – 8.8/ZP
7	2	QSD-DX25F	Screw-Self Drilling - TEK Screw & Washer - 5.5x25mm A2/SS 7504K

8 General Terms and Conditions

Please refer to the 'Terms & Conditions' section on the Collinson website:

collinson.co.uk/about-us

Authorised dealer

